



Remote Probe Accessory



Part Number 605830-0001.
Maintains comfortable viewing by providing optical pickup of RPM sources in tight or hard to access areas. Easy plug-in connection.

Shirt-pocket size. Contacting or non-contacting . . . an essential part of your tool kit.

The Dynapar brand Series HT50 hand tachometer provides a convenient, accurate means of measuring rotary or surface speeds on all types of machinery. For non-contacting measurement, the tachometer optically detects a reflective target on the rotating object to read revolutions per minute. Where in-contact measurement is desired, an accessory adaptor is used with the appropriate device – a wheel for surface speed or rubber tip for shaft rotation.

- Optical non-contact or in-contact measurement
- Compact and lightweight
- Simple push button operation
- Automatic display hold for three minutes or until another reading
- 6.0 to 99999 RPM measurement range with 0.1 resolution
- Automatic shutoff for power savings

The Series HT50 hand tachometer can be used for everyday checks of motors, conveyors, HVAC equipment and line speeds. It also provides an excellent reference source for checking speed indicators on machinery control panels.

SPECIFICATIONS

Measurement Range: 6.0 to 99999.9 RPM; 3.00 to 3000.00 meters or yards per minute using in-contact adaptor and appropriate wheel

Resolution: 0.1 RPM

Accuracy: RPM: $\pm 0.01\%$, Surface Speed: $\pm 0.05\%$; and ± 1 digit

Optical Range: 50 to 300 mm (2 to 12 inches) using reflective tape

Update Time: 1 to 10 seconds sample time

Display: 6 digit LCD; low battery and reflective light input indicators

Display Hold: 3 minutes from last measurement then auto power-off

Power Requirements: (4) 1.5V batteries, AAA size, included. 20 hours continuous measurement

Operating Temperature: 40° to +104°F (5° to +40°C)

Typical Applications:

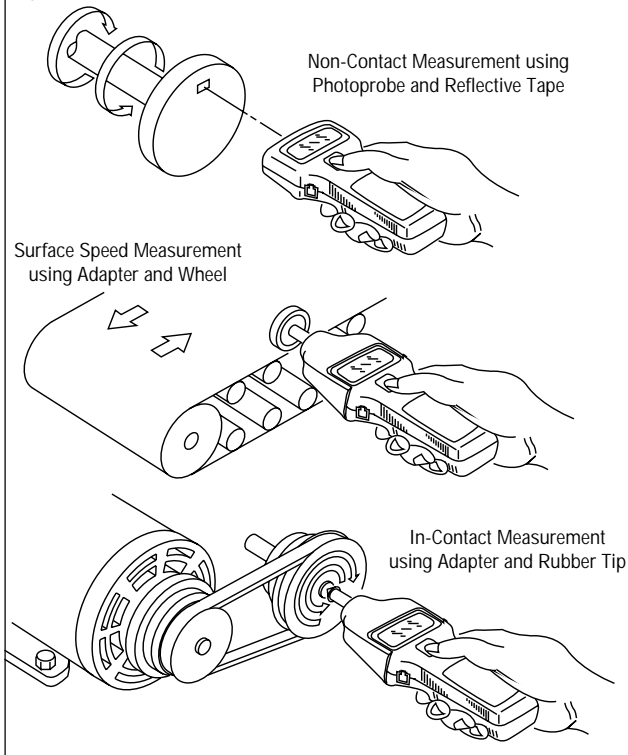

Model No.	Description
HT50 02	Hand Tachometer System (Includes: Hand Tachometer; In-Contact Adaptor; Rubber Tips (3 pcs.); Reflective Tape (10 sheets); Surface Speed Wheels (1/10 m/min and 1/10 yd/min); Carrying Case; Dry Batteries (4-AAA size, 1.5 V); Instruction Manual
605830-0001	Accessory Remote Probe
0576008-394	Replacement Rubber Tip for In-contact Adaptor
0576008-395	Replacement 1/10 Yard Wheel
0576008-396	Replacement 1/10 Meter Wheel
605831-0002	Replacement In-contact Adaptor
0616483-001	Reflective Tape (Replacement)

Dimensions:

